



# N 203 ECP

- Popular item  
- SKF Explorer

## Cylindrical roller bearings, single row

### Bearing data

[Tolerances](#),  
Normal (metric), P6, Normal (inch),  
[Radial internal clearance](#),  
cylindrical bore, tapered bore,  
[Axial internal clearance](#),  
NUP, NJ + HJ

### Bearing interfaces

[Seat tolerances for standard conditions](#),  
[Tolerances and resultant fit](#)

## Technical specification

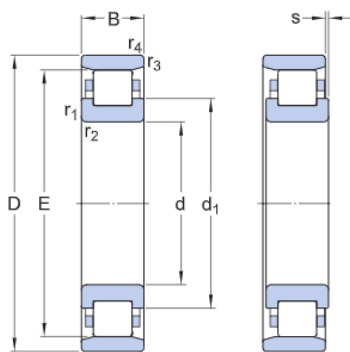

### DIMENSIONS

d	17 mm	Bore diameter
D	40 mm	Outside diameter
B	12 mm	Width
d1	≈25 mm	Shoulder diameter of inner ring
E	35.1 mm	Raceway diameter of outer ring
r1,2	min.0.6 mm	Chamfer dimension
r3,4	min.0.3 mm	Chamfer dimension
s	max.1 mm	Permissible axial displacement

### ABUTMENT DIMENSIONS

da	min.20.7 mm	Diameter of spacer sleeve
da	max.33 mm	Diameter of spacer sleeve
Da	min.37 mm	Diameter of housing abutment
Da	max.37.1 mm	Diameter of housing abutment
	max.0.6	Radius of

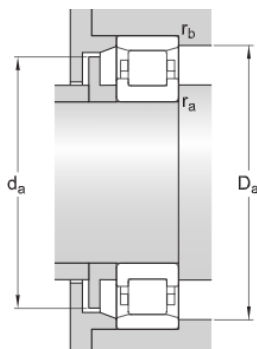

ra	mm	fillet
rb	max.0.3 mm	Radius of fillet

## CALCULATION DATA

Basic dynamic load rating	C	20 kN
Basic static load rating	C <sub>0</sub>	14.3 kN
Fatigue load limit	P <sub>u</sub>	1.73 kN
Reference speed		20 000 r/min
Limiting speed		22 000 r/min
Minimum load factor	k <sub>r</sub>	0.12
Limiting value	e	0.2
Axial load factor	Y	0.6

## MASS

Mass		0.066 kg
------	--	----------